



LED MODULES

SA R-UV LED(2835) Series

Features

- Compact design and easy installation.
- Constant Current (Non-DALI Compatible).
- 170° Wide beam Angle
- Suitable for both indoor and outdoor lighting applications.
- Available colour : Pure White, Red, Blue, Green.
- LED Type: 2835 LED Chip
- 5Years Warranty

Specification

1LED_0.36W

| Item Code | Power(W) | Luminous Flux(lm) | Colour | CCT(K)/Wavelength |
|-----------|----------|-------------------|---------|-------------------|
| SA 919A | 0.36 | 53 | PW ○ | 6,500 |
| SA 9194 | 0.36 | 53 | Red ● | 620~625 |
| SA 9195 | 0.36 | 53 | Blue ● | 460~463 |
| SA 9196 | 0.36 | 53 | Green ● | 520~525 |

2LED_0.72W

| Item Code | Power(W) | Luminous Flux(lm) | Colour | CCT(K)/Wavelength |
|-----------|----------|-------------------|---------|-------------------|
| SA 929A | 0.72 | 108 | PW ○ | 6,500 |
| SA 9294 | 0.72 | 108 | Red ● | 620~625 |
| SA 9295 | 0.72 | 108 | Blue ● | 460~463 |
| SA 9296 | 0.72 | 108 | Green ● | 520~525 |

3LED_1W

| Item Code | Power(W) | Luminous Flux(lm) | Colour | CCT(K)/Wavelength |
|-----------|----------|-------------------|---------|-------------------|
| SA 939A | 1 | 150 | PW ○ | 6,500 |
| SA 9394 | 1 | 150 | Red ● | 620~625 |
| SA 9395 | 1 | 150 | Blue ● | 460~463 |
| SA 9396 | 1 | 150 | Green ● | 520~525 |



Technical Characteristics

| | |
|---------------------|--|
| Voltage | DC12V |
| Viewing Angle | 170° |
| Current Dissipation | 0.03A(0.36W) / 0.06A(0.72W) / 0.083A(1W) |
| Efficiency | 150lm/W |
| Colour | PW / R / G / B |
| IP Rating | IP67 |
| CRI(Ra) | 80+ |
| PCB | FR4 |
| LED Type | 2835 LED |
| Wire | 18AWG |

Certification



Temperature Ranges

| | |
|-----------------------|---------|
| Operating temperature | -25~60° |
| Storage temperature | -25~70° |

Warranty

| | |
|----------|---------|
| Warranty | 5 Years |
|----------|---------|

Physical Characteristics

Profile Drawings

1 LED
Weight : 348g

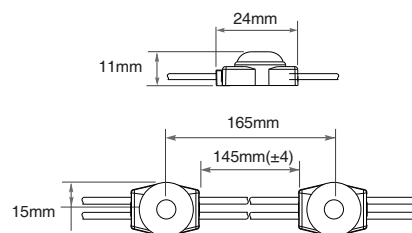

2 LED
Weight : 400g

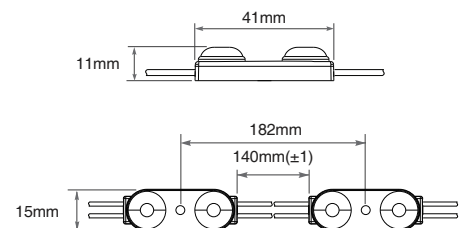

3 LED
Weight : 420g

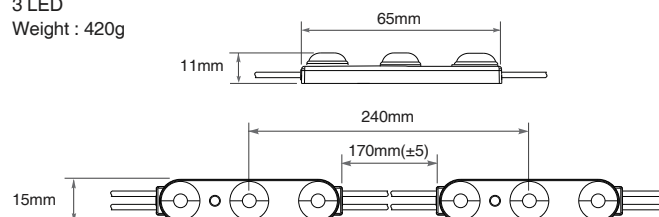

Module Layout Guides

3 LED

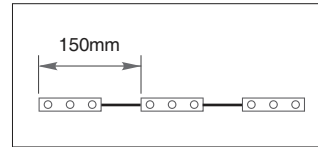

2 LED

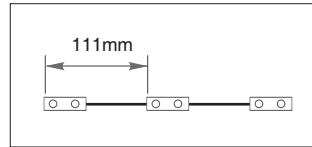

1 LED

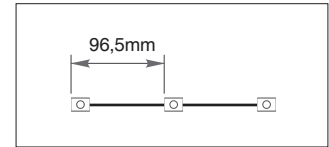

Lighting Distribution

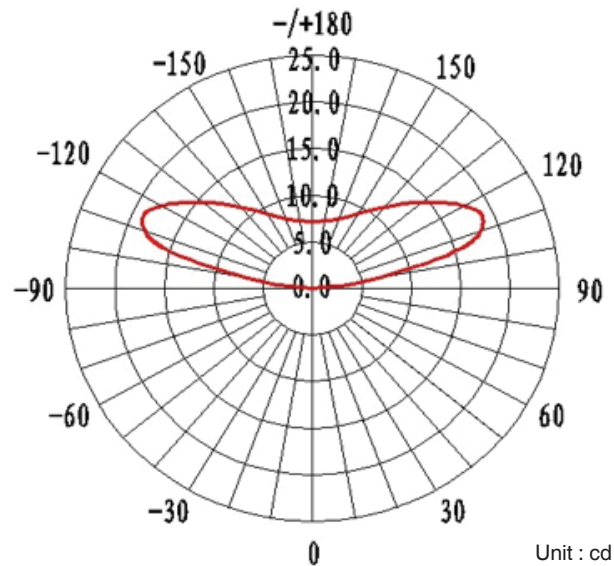

Average Beam Angle(50%) : 159.7°

Max in series 50 EA

