



*50 METRE / ROLL

ACCESSORIES

LED WIRE UL 2464 Series

Features

- Application: Internal wiring of appliances.
- Characteristics : Rating : 300V, 80°C
- Extruded construction, flat ribbon type wire.
- Certifications : AWM UL 2464 VW-1 FT1
- TIN_COATED.
- Best for outdoor condition.

Specification

*Unit : mm

Item Code	Standard	No. of Core	No & Dia of Conductor*	Insulation Colour
SA916	16 AWG	2C	26 TA / 0.254	Black & Red
SA914	18 AWG	2C	41 TA / 0.157	Black & Red
SA9142 WRGB	18 AWG	4C	41 TA / 0.16	Blue & Red & Green & White

Technical Characteristics

Rated Voltage	80°
Rated Temperature	300V
Flame Retardant	UL VW-1, FT1
Sheath Material	PVC
Insulation Material	PVC
Conductor Material	Copper
Material Shape	Round Wire
Length	50 Metre /Roll

Certification

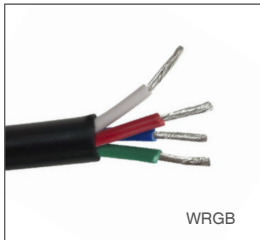
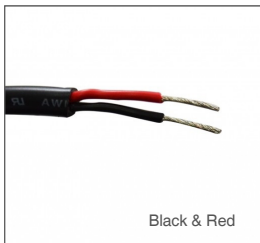
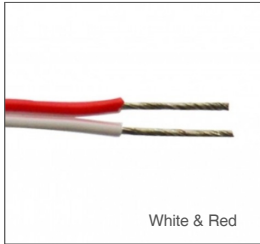

Physical Characteristics

Schematic Cross Section

Front view (2 Core)

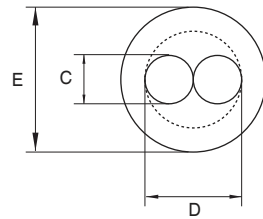

Front view (4 Core)

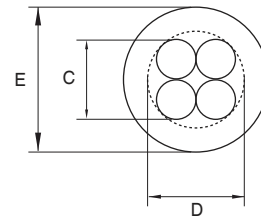

Dimensions (mm)

*Unit : mm

Item Code	Standard	No. of Core	Insulation Dia (C)*	Overall Outer (D)*	Sheath Dia (E)*
SA916	16 AWG	2C	2.85 ± 0.1mm	5.7 ± 0.1mm	6.4 ± 0.1mm
SA914	18 AWG	2C	2.0 ± 0.05mm	4.0 ± 0.1mm	4.7 ± 0.05mm
SA9142	18 AWG	4C	2.0 ± 0.02mm	4.0 ± 0.1mm	6.5 ± 0.05mm